

NCF CABINET

P/N:NCF

S/N:NO 1

P/N:NCF



CABINET,F style.

STANDARD

Comply with ANSI/EIARS-310-D, DIN41491;PART1, IEC297-2, DIN41494;PART7, GB/T3047.2-92 standard. Compatible with metric-ETSI and 19 inch international standard .

FEATURES

- Surface finish: degreasing, pickling, phosphoric, powder coating . The thickness of powder coating is 80µm-100µm .
- Curved perforated front door and double-section rear door enable equipment protection, reliable operation with ventilation rate above 80% .
- Double-section side panels, each panel can be easily assembled separately.
- Top and bottom wiring channel can be closed and adjustable.
- Backside with a pair of vertical cable management .
- Mounting rail with U mark.
- Efficient and solid cabinet connection.
- With earthing kits.
- Advanced lock .
- Optional plinth to meet under-base wiring, ventilation and rat-proof .
- Adjustable feet and heavy duty castors are available at the same time , static loading: 1000KG .
- Full range of optional accessories.

MATERIALS

Cold-rolled steel sheet. Thickness for frame 2.0mm, mounting rail 2.0mm, side panel 1.5mm, fixed shelf 1.5mm

APPLICATION

Widely applied in Finance, Securities and Data Centre and adpted by professional servers' network providers, as IBM, SUN, HP, COMPAQ, DELL, etc .



Frame with scale mark



Mounting rail with U mark



Connection kits



Removable double-section side panel



Backside with a pair of vertical cable management



Enhanced hinge

NCF CABINET

P/N:NCF

STRUCTURAL (WIDTH 600MM)

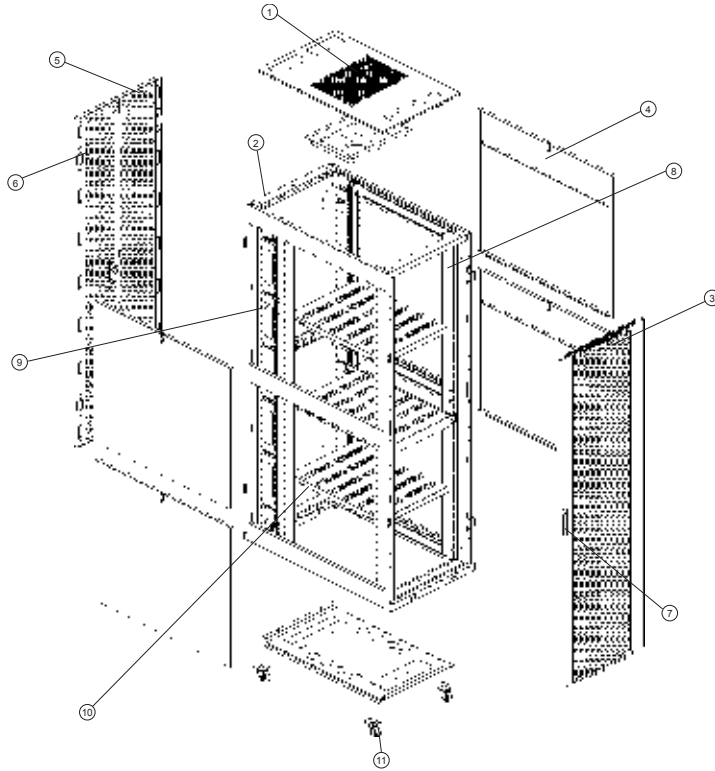

- 1.Top Cover
- 2.Frame
- 3.Front Door
- 4.Side Door
- 5.Left Rear Door
- 6.Right Rear Door
- 7.Lock
- 8.Mounting Rail
- 9.Vertical cable management
- 10.Fixed shelf
- 11.Heavy duty caster

DIMENSION (MM)

mm Unit of Measurement:mm

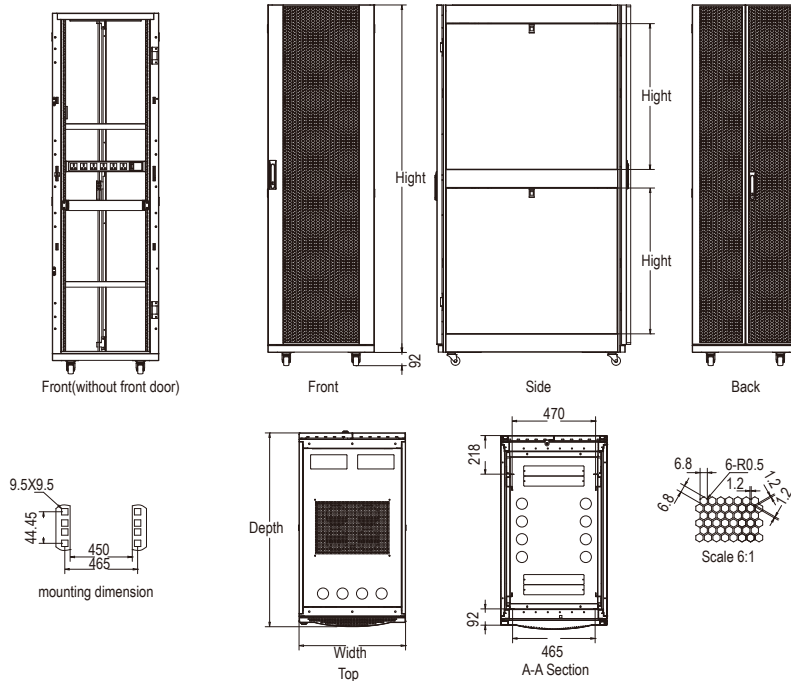

NCF CABINET

P/N:NCF

STANDARD ACCESSORIES

S/N	Specification	Qty	Unit	Material	surface finish	Remark
1	Top cover	1	Pcs	1.5mm cold rolled steel	Powder coated	---
2	Frame	2	Pcs	2.0mm cold rolled steel	Powder coated	---
3	Front door	1	Pcs	1.5mm cold rolled steel	Powder coated	K type door
4	Side panel	4	Pcs	1.5mm cold rolled steel	Powder coated	With lock
5	Left rear door	1	Pcs	1.5mm cold rolled steel	Powder coated	F type door
6	Right rear door	1	Pcs	1.5mm cold rolled steel	Powder coated	F type door
7	Lock	6	Pcs	---	---	---
8	Mounting rail	4	Pcs	2.0mm cold rolled steel	Powder coated	---
9	Mounting angle	6	Pcs	1.5mm cold rolled steel	Powder coated	---
10	Spacer	12	Pcs	---	---	Cabinet width:800mm
11	Fixed shelf	2	Pcs	1.5mm cold rolled steel	Powder coated	---
12	Vertical cable management	1	Pcs	1.5mm cold rolled steel	Powder coated	---
13	Heavy duty castors	4	Pcs	---	---	---
14	Feet	4	sets	---	---	---
15	Cage and nuts	40	Pcs	---	---	---
16	Fan	4	Pcs	---	---	---
17	6-way power strip	1	Pcs	---	---	2 fans for 600mm depth
18	Wrench	1	Pcs	---	---	---

NCF CABINET

P/N:NCF

ORDER INFORMATION

Part No	Capacity/U	Width/mm	Depth/mm	Height/mm	Carton measurement			Volume/CBM
					Width/m	Depth/m	Height/m	
NCF37-66-##☆	37U	600	600	1800	0.65	0.65	1.80	0.7605
NCF37-68-##☆		600	800		0.65	0.85		0.9945
NCF37-610-##☆		600	1000		0.65	1.05		1.2285
NCF37-88-##☆		800	800		0.85	0.85		1.3005
NCF37-810-##☆		800	1000		0.85	1.05		1.6065
NCF42-66-##☆	42U	600	600	2000	0.65	0.65	2.00	0.845
NCF42-68-##☆		600	800		0.65	0.85		1.105
NCF42-610-##☆		600	1000		0.65	1.05		1.365
NCF42-88-##☆		800	800		0.85	0.85		1.445
NCF42-810-##☆		800	1000		0.85	1.05		1.785
NCF47-66-##☆	47U	600	600	2200	0.65	0.65	2.20	0.9295
NCF47-68-##☆		600	800		0.65	0.85		1.2155
NCF47-610-##☆		800	1000		0.65	1.05		1.5015
NCF47-88-##☆		800	800		0.85	0.85		1.5895
NCF47-810-##☆		800	1000		0.85	1.05		1.9635

NCF CABINET
CABINET & ENCLOSURE







NCF CABINET

P/N: NCF

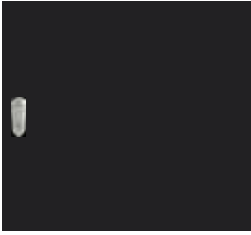
REMARKS

* = Front door # = Rear door

DOORS

A= steel casement door	K= Curved perforated door	L= double swing steel door	N= Smoky-gray glass door with both sides punched
 	 	 	 

COLOR

☆ = Colors A= Black(RAL9004) B=Gray(RAL7044)

